

MOSQUITERA PLISADA MANUAL DE MONTAJE

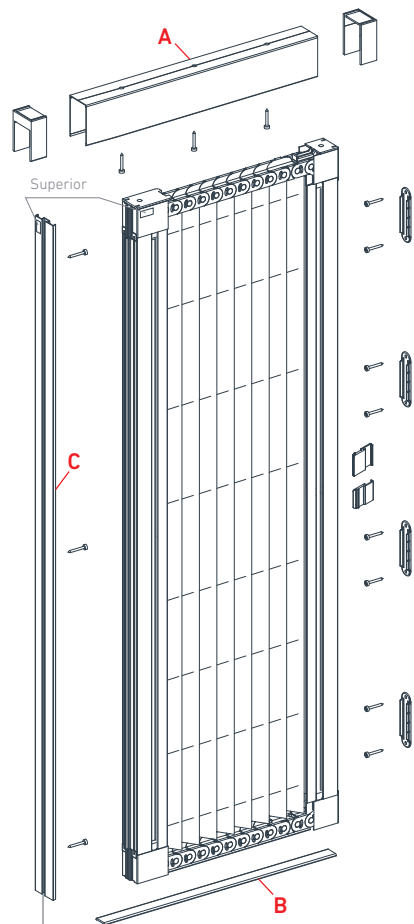

Perfil no incluido en modelo Plisada de 2 Puertas

01 APERTURA DERECHA

PASO 1.1

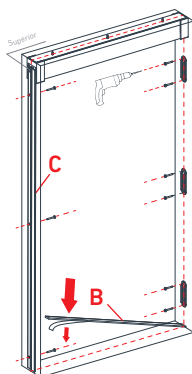

PASO 1.2

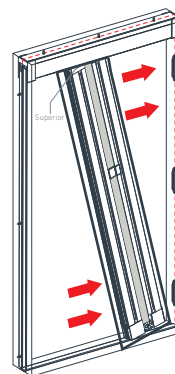

PASO 1.3

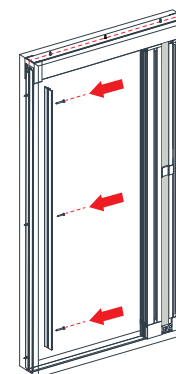

PASO 1.4

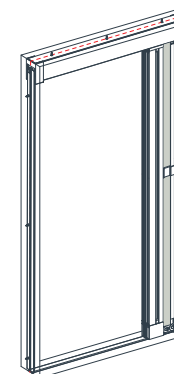

02 APERTURA IZQUIERDA

PASO 2.1

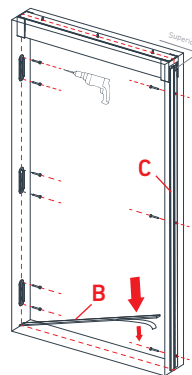

PASO 2.2

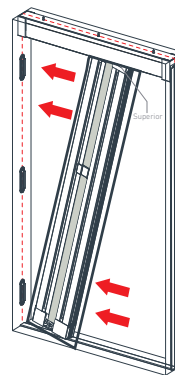

PASO 2.3

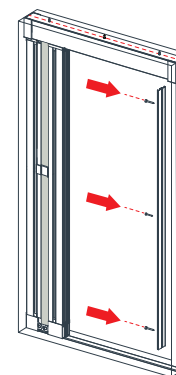

PASO 2.4

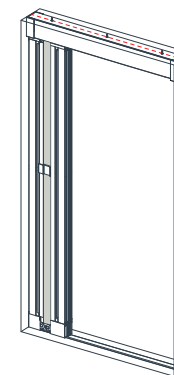

! ATENCIÓN

NO EMPIECE A MONTAR SIN LEER TODAS LAS INSTRUCCIONES

- Tenga la precaución de no desplegar la mosquitera plisada antes de que este instalada con sus soportes en la pared.
- No intentar instalar ningún tipo de maneta o tirador en los perfiles.