

saxun[®]

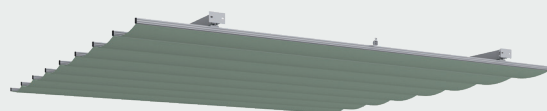

ANEAS 80x40

TECHNICAL MANUAL



ENG

INDEX

1. GENERAL RECOMMENDATIONS REGARDING SAFETY, USE AND RESTRICTIONS	5
2. PRODUCT DESCRIPTION	6
2.1 PARTS LIST ANEAS 80x40 WALL TO WALL	6
2.2 PARTS LIST ANEAS 80x40 PATIO COVER WITHOUT CROSSBAR	7
2.3 PARTS LIST ANEAS 80x40 WITH BARS	8
3. WIND RESISTANCE, CUTTING BOARDS AND SELECTION	9
3.1 WIND CLASSIFICATION (EN 13561)	9
3.2 OPTIONAL POLE INCLINATION	9
4. PROFILES AND ACCESSORIES	10
5. ASSEMBLY AND INSTALLATION	14
5.1 ADJUSTABLE CORNER JOINT	14
5.2 FIXED CORNER JOINT	14
5.3 T-JOINT	15
5.4 CAST IRON FLOOR SUPPORT JOINT	15
5.5 FOOT SUPPORT JOINT	16
5.6 GUIDE SUPPORT JOINT	16
5.7 CAPITAL JOINT	17
5.8 END HOOK GUIDE SUPPORT JOINT	17
5.9 SMALL PULLEY DETAIL (DOUBLE TROLLEY INSTALLATION)	18
5.10 CANOPY OPTION	19
5.11 SUPPORT FIXING INSTALLATION	20
6. MAINTENANCE	21
6.1 CLEANING AND CARE	21
7. ANNEX I	22
7.1 DISASSEMBLY AND DISPOSAL OF THE PACKAGING AND COMPONENTS OF THE PRODUCT AT THE END OF ITS USEFUL LIFE	22

IMPORTANT

It is important to read these instructions carefully before installation, operation, repair or first use, in order to protect the safety of persons and to the integrity of the product.

1. GENERAL RECOMMENDATIONS REGARDING SAFETY, USE AND RESTRICTIONS

In order to ensure the safe assembly, use and maintenance of this product, a number of precautionary measures must be taken. Please observe the following warnings and instructions, for the safety of all concerned.

Please contact your distributor with any queries.

- This manual is intended as a reference for experienced professionals and should therefore not be used by DIY amateurs or trainee fitters.
- This manual describes the installation of the product assembly components, and refers to the electrical control installation manuals. If necessary, this manual should be supplemented with instructions for any additional components not described herein.
- Please read this manual carefully before starting work.
- Some components may be sharp or have jagged edges. It is therefore advisable to wear safety gloves.
- All parts supplied have been designed specifically for this product. The replacement or addition of other parts may have a negative effect on the safety of the product and its warranty. In addition, the CE certification of this product will become invalid if any parts are replaced or if the installation is not carried out in accordance with the instructions in this manual. The installer shall accept full responsibility in this regard.
- Ensure that the assembly area is sufficiently illuminated. Remove any obstacles or dirt. Make sure nobody is present besides the fitters. Unauthorised

persons (especially children!) may interfere or cause hazards during installation.

Before assembly, it is very IMPORTANT for your safety and that of the product to follow all the recommendations listed below. A poor-quality installation may cause harm to people or damage to the installation itself.

Once the product has been unpacked, the professional fitter has to check its integrity. Before starting the installation, the arrangement of all components and tools must be checked in order to install the product correctly. In case of doubt, contact **Giménez Ganga's** technical department.

Under no circumstances should a damaged product be installed, as it may damage the equipment and create situations that are dangerous for people.

These systems are exclusively intended for the use for which they were designed. Any other use is inappropriate, and therefore dangerous.

The system installation must always be performed by a professional fitter, respecting the manufacturer's indications, as well as knowing and applying all the regulations in force.

IMPORTANT

For power operated products, the existing voltage must be checked before installation.

The connection must always be a grounded connection. Otherwise, do not continue the installation as it may be dangerous.

Should any damage and/or a system malfunction be detected, **do not continue** with the installation.

The manufacturer will not be liable for damage caused during the installation due to non-compliance with these recommendations.

2. PRODUCT DESCRIPTION

2.1 PARTS LIST ANEAS 80x40 WALL TO WALL

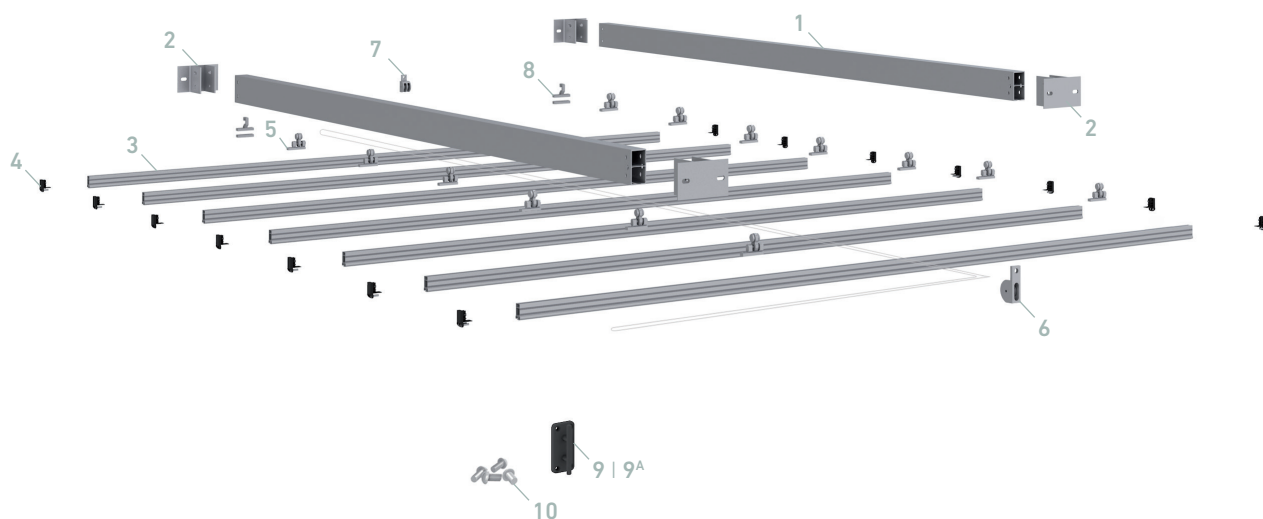

CODE	DESCRIPTION
1 022061	Aluminium guide tube 80x40x20 mm
2 022776	Aluminium wall bracket 80x40 mm
3 022520	Double pole cover with holes
4 022277	Cap for double fabric profile with hole
5 022379	Reinforced nylon flange pulley with bearings
6 022084	Simple pulley

CODE	DESCRIPTION
7 022593	Double pulley
8 022581	End hook kit
9 022129	Wall cleat for string plastic
9 ^A 022262	Wall cleat for string metallic
10 022115	Bag of screws for bracket
11 022111	Flange with string

2.2 PARTS LIST ANEAS 80x40 PATIO COVER WITHOUT CROSSBAR

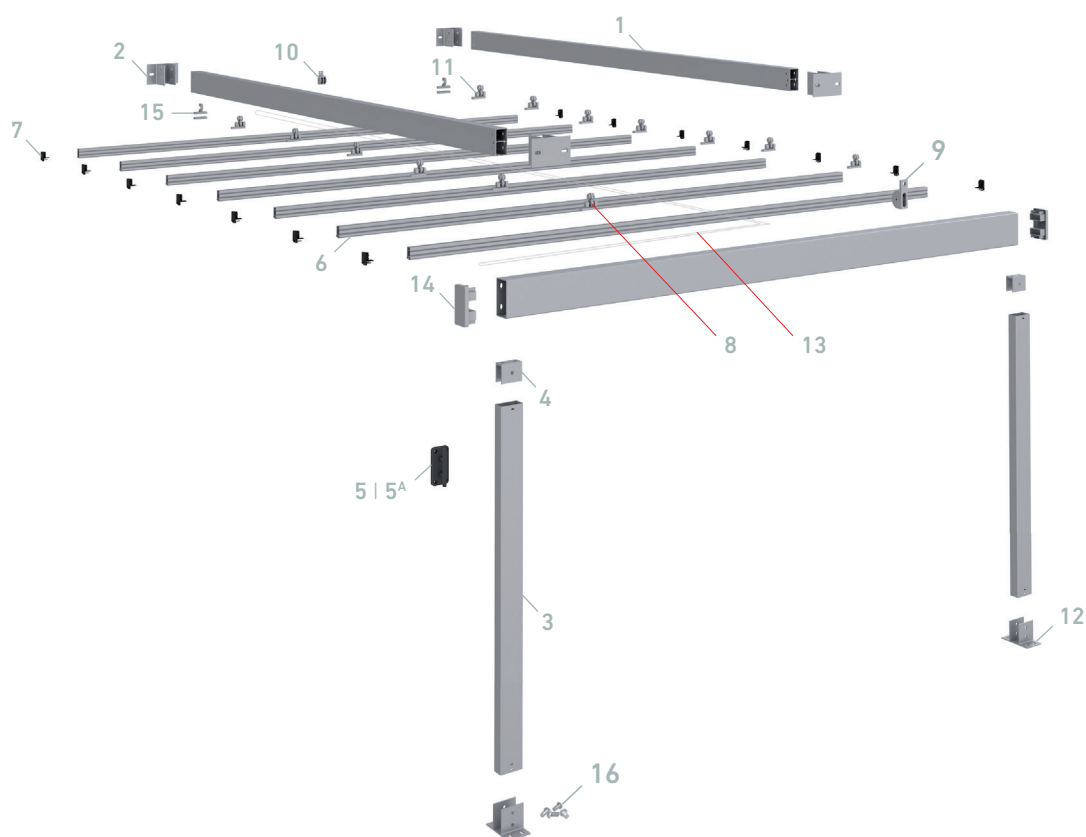

CODE	DESCRIPTION
1	022061 Aluminium guide tube 80x40x20 mm
2	022776 Aluminium wall bracket 80x40 mm
3	022062 Structural aluminium bar 80x40x20 mm
4	022068 End joint for structural aluminium tube 80x40 mm
5	022129 Wall cleat for string plastic
5 ^A	022262 Wall cleat for string metallic
6	022520 Double pole cover with holes
7	022277 Cap for double fabric profile with hole
8	022379 Reinforced nylon flange pulley with bearings

CODE	DESCRIPTION
9	022084 Simple pulley
10	022593 Double pulley
11	022581 End hook kit
12	022106 Aluminium floor bracket 80x40 mm
13	022128 Rope for awning
14	022107 Rectangular bracket cover 80x40 mm reinforced nylon
15	022111 Flange with string
16	022115 Bag of screws for bracket

2.3 PARTS LIST ANEAS 80x40 PATIO COVER WITH CROSSBAR

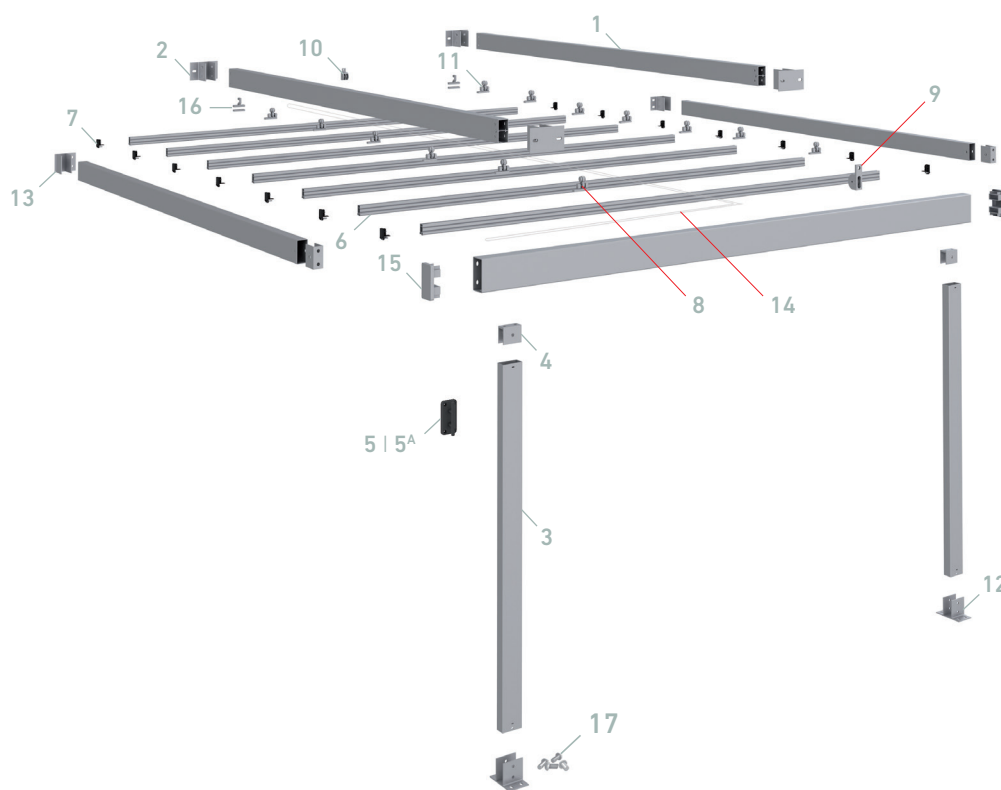

CODE	DESCRIPTION
1 022061	Aluminium guide tube 80x40x20 mm
2 022776	Aluminium wall bracket 80x40 mm
3 022062	Structural aluminium bar 80x40x20 mm
4 022068	End joint for structural aluminium tube 80x40 mm
5 022129	Wall cleat for string plastic
5 ^A 022262	Wall cleat for string metallic
6 022520	Double pole cover with holes
7 022277	Cap for double fabric profile with hole
8 022379	Reinforced nylon flange pulley with bearings

CODE	DESCRIPTION
9 022084	Simple pulley
10 022593	Double pulley
11 022581	End hook kit
12 022106	Aluminium floor bracket 80x40 mm
13 022067	Lateral aluminium floor bracket 80x40 without drills
14 022128	Rope for awning
15 022107	Rectangular bracket cover 80x40 mm reinforced nylon
16 022111	Flange with string
17 022115	Bag of screws for bracket

3. WIND RESISTANCE, CUTTING BOARDS AND SELECTION

3.1 WIND CLASSIFICATION (EN 13561)

WIND RESISTANCE CLASSES

Classes	0	1	2	3
Pressure (N/m ²)	<40	40	70	110
Speed (km/h)	<28	28	38	49

WIND CLASSIFICATION EN 13561

PROJECTION	2 GUIDES												3 GUIDES				
	WIDTH																
	2.00	2.25	2.50	2.75	3.00	3.25	3.50	3.75	4.00	4.25	4.50	4.75	5.00	5.50	6.00	6.50	7.00
2.00	3	3	3	3	3	3	3	3	3	3	3	3	3	2	2	2	2
2.50	3	3	3	3	3	3	3	3	3	3	3	3	3	2	2	2	2
3.00	3	3	3	3	3	3	3	3	3	3	3	3	3	2	2	2	2
3.50	3	3	3	3	3	3	3	3	3	3	3	3	3	2	2	2	2
4.00	3	3	3	3	3	3	3	3	3	3	3	3	3	2	2	2	2
4.50	3	3	3	3	3	3	3	3	3	3	3	3	3	2	2	2	2
5.00	3	3	3	3	3	3	3	3	3	3	3	3	3	2	2	2	2
5.50	2	2	2	2	2	2	2	2	2	2	2	2	2	1	1	1	1
6.00	2	2	2	2	2	2	2	2	2	2	2	2	2	1	1	1	1
6.50	2	2	2	2	2	2	2	2	2	2	2	2	2	1	1	1	1
7.00	2	2	2	2	2	2	2	2	2	2	2	2	2	1	1	1	1

Class 1	≈ 29 km/h	Class 2	≈ 38 km/h	Class 3	≈ 48 km/h
---------	-----------	---------	-----------	---------	-----------

3.2 OPTIONAL POLE INCLINATION

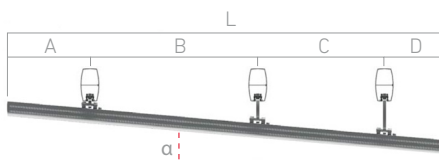

L	A=D	B	C	α
3000	540	1100	825	2.1°
3500	655	1250	940	1.8°
4000	730	1450	1090	1.6°
4500	805	1650	1240	1.4°
5000	925	1800	1350	1.3°
5500	1000	2000	1500	1.1°
6000	1075	2200	1650	1.0°

$$A = 0.5L - 0.875 = D$$

$$C = 0.75B$$

$$\alpha = \arctan \frac{40}{B}$$

4. PROFILES AND ACCESSORIES

022062 Structural tube
80x40x2 mm aluminium

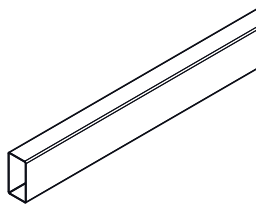

022060 Guide tube
40x40 mm aluminium

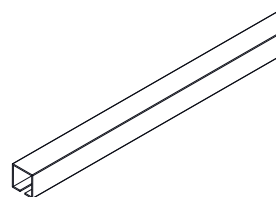

022540 Structural tube
80x40 mm for power strip

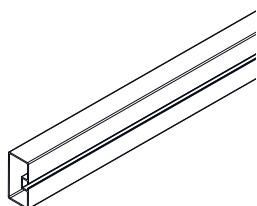

022520 Double pole
aluminium

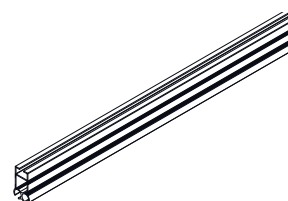

022350 Structural tube
40x40x2 mm aluminium

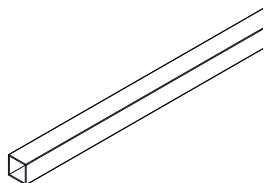

022277 Double pole cover
with hole

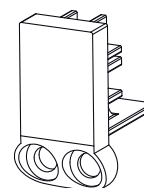

022061 Guide tube
80x40x2 mm aluminium

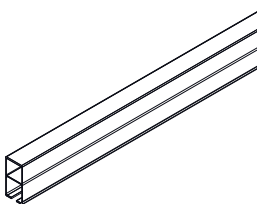

022105 Double pole cover
without hole

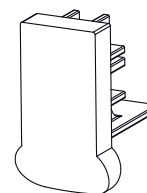

022535 Guide tube
80x40 mm for power strip

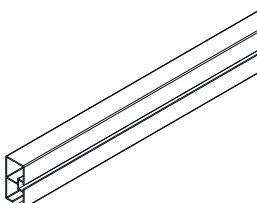

022115 Bag of screws
for Supports

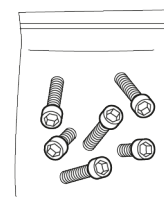

022379 Reinforced nylon flange pulley
with stainless steel screw/nut bearings

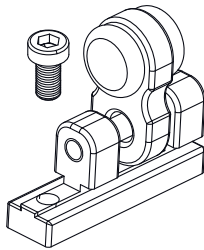

022994 Pole power strip
35 mm with screw

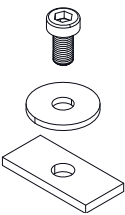

022560 Fixed profile flange
With power strip and screws

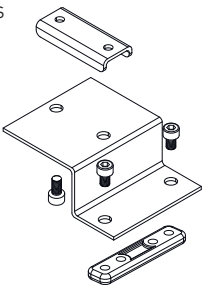

022756 Reinforced nylon flange pulley
with 60 mm bearings

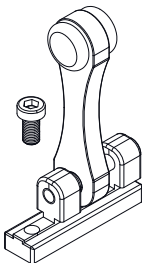

022107 Rectangular support cap
80x40 mm reinforced nylon

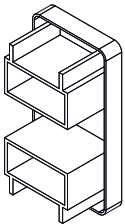

022757 Reinforced nylon flange pulley
with 90 mm bearings

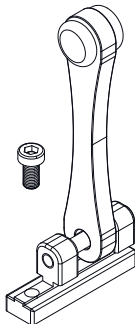

022581 End hook set

022582 End hook set 60 mm

022377 End hook set 90 mm

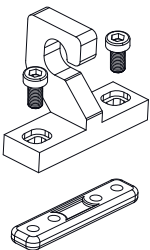

022111 Flange with cable tie

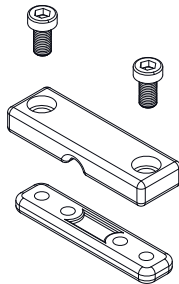

022328 Set Bar caps
40x40 mm squared

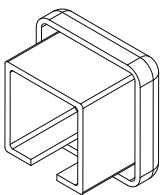

022067 Side foot support 80x40 mm
aluminium without holes

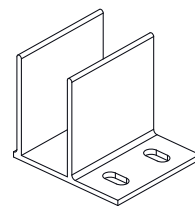

022129 Plastic fitting
pole awning

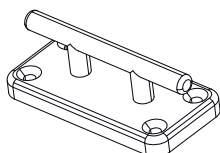

022768 Short aerial support
40x40 mm aluminium

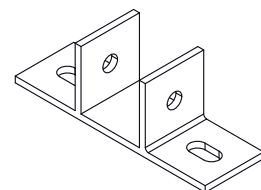

022775 Guide support 40x40 mm
aluminium with holes

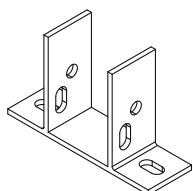

022068 Inner joint profile
80x40 mm aluminium

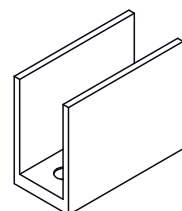

022113 Foot support 40x40 mm
aluminium with holes

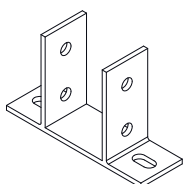

022786 Cast iron floor support for
aluminium pole 80x40 mm

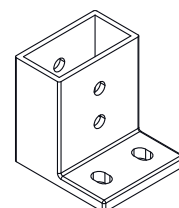

022776 Guide support 80x40 mm
aluminium

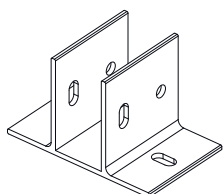

022697 Male adjustable corner joint
aluminium pole 80x40 mm

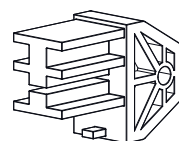

022106 Foot support 80x40 mm
lacquered aluminium

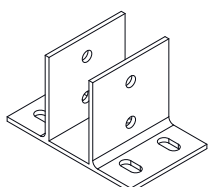

022907 Set Corner joint
adj. pole

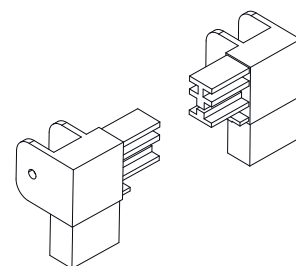

022778 Foot support 80x40 mm
aluminium without holes

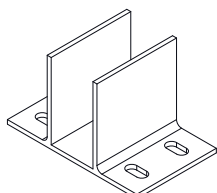

022588 Corner joint
aluminium pole 80x40 mm

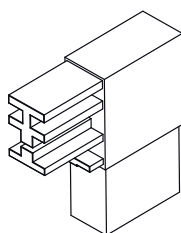

022773 T-support aluminium
pole 80x40 mm

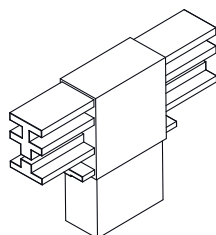

022564 Capital for leg 80x40 mm
aluminium w/screws

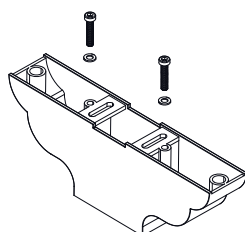

022390 Capital for leg 80x40 mm
aluminium without screws

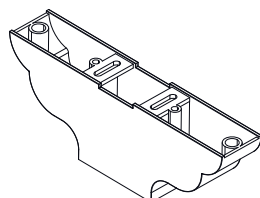

022758 Double pulley
nylon

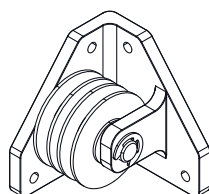

024041 Double plastic trolley

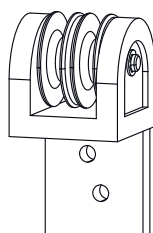

5. ASSEMBLY AND INSTALLATION

5.1 ADJUSTABLE CORNER JOINT

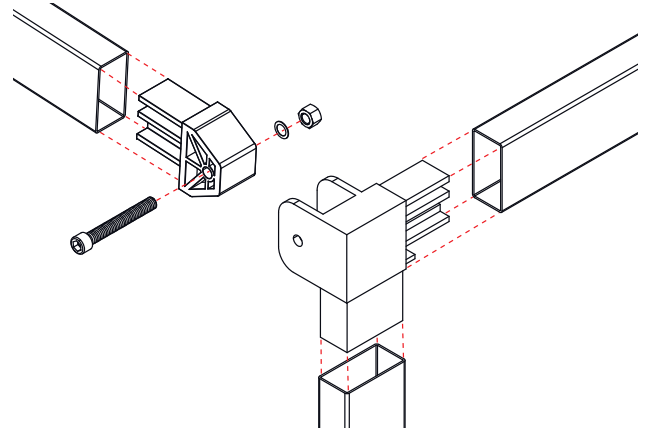
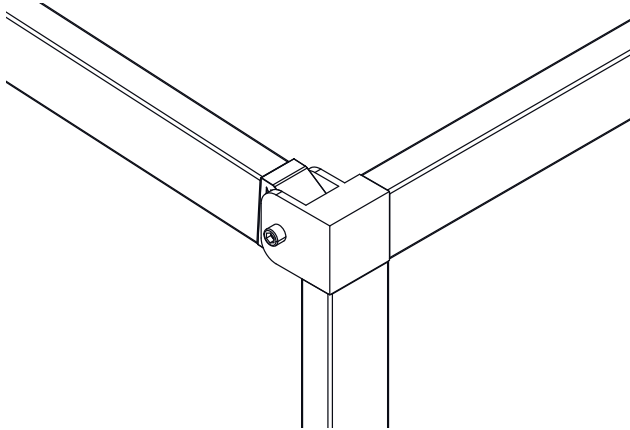

5.2 FIXED CORNER JOINT

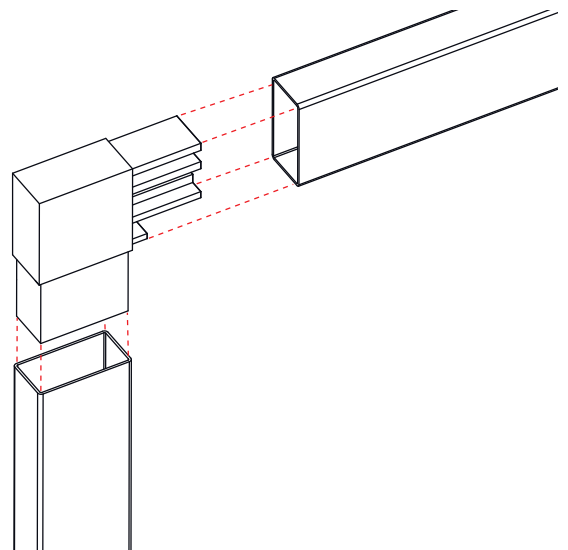
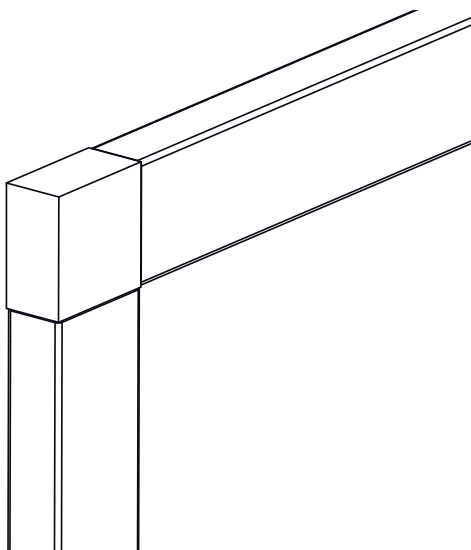

5.3 T-JOINT

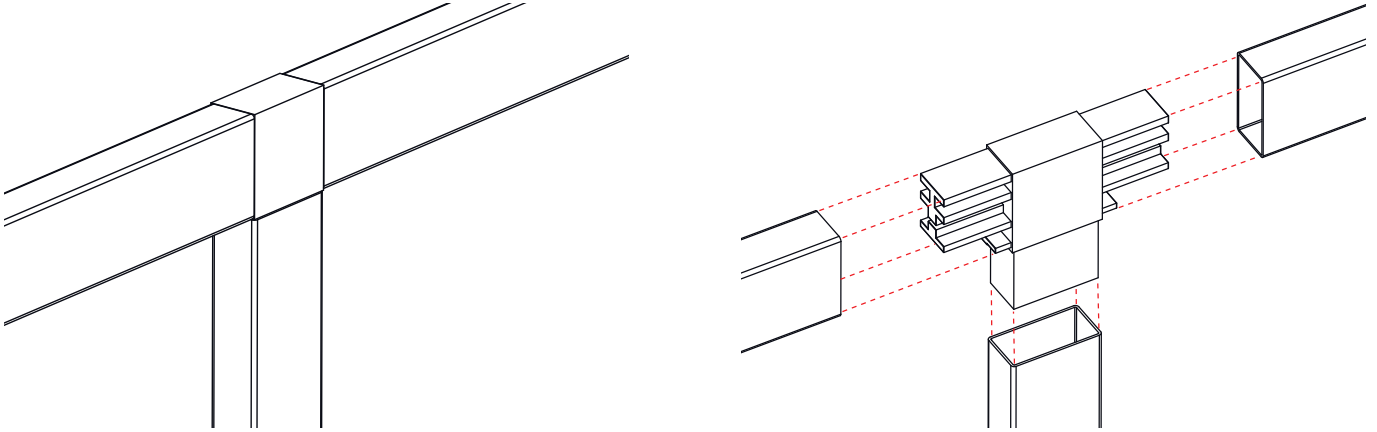

5.4 CAST IRON FLOOR SUPPORT JOINT

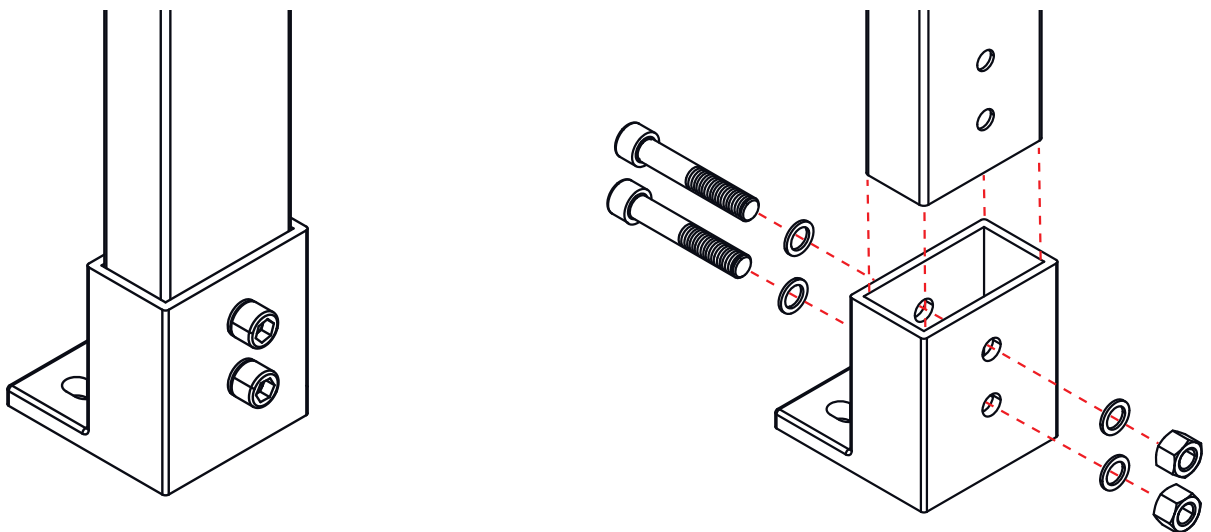

5.5 FOOT SUPPORT JOINT

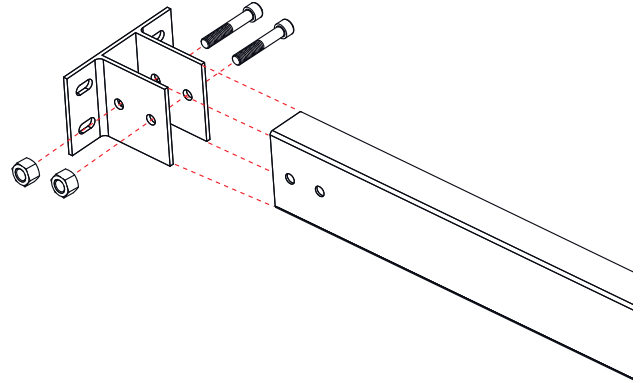
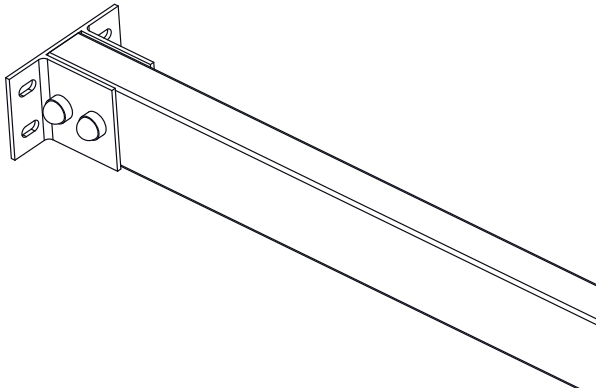

5.6 GUIDE SUPPORT JOINT

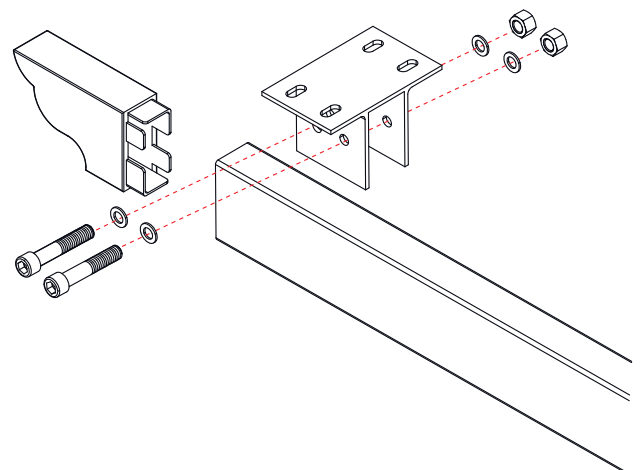
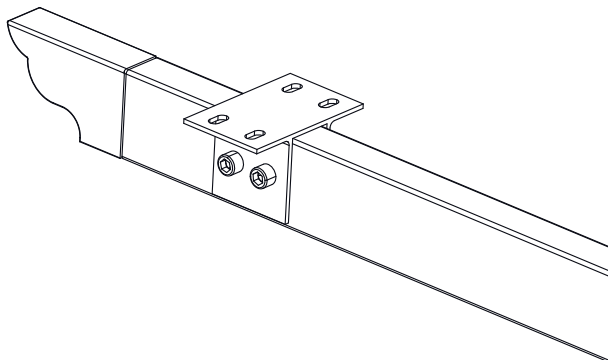

5.7 CAPITAL JOINT

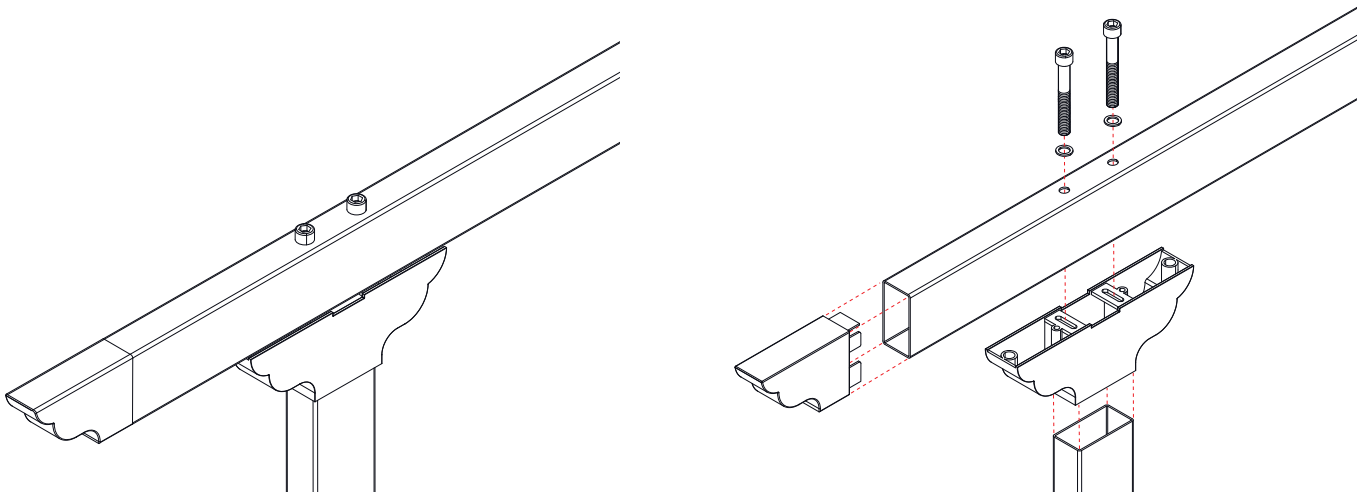

5.8 END HOOK GUIDE SUPPORT JOINT

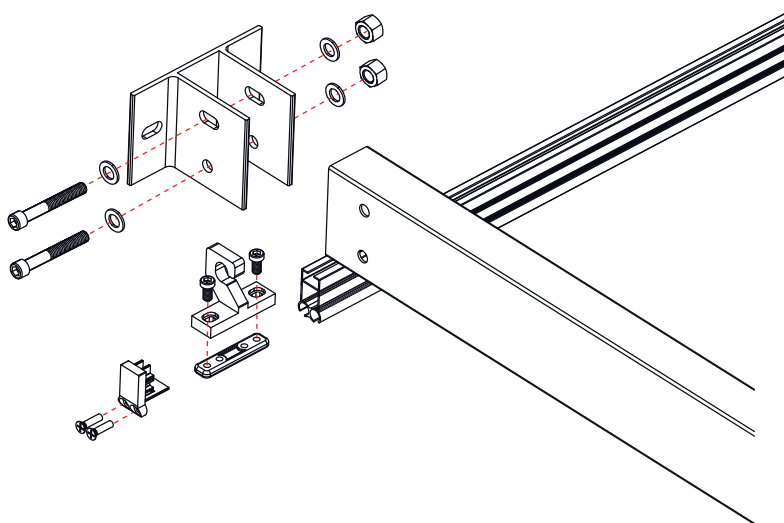

5.9 SMALL PULLEY DETAIL (DOUBLE TROLLEY INSTALLATION)

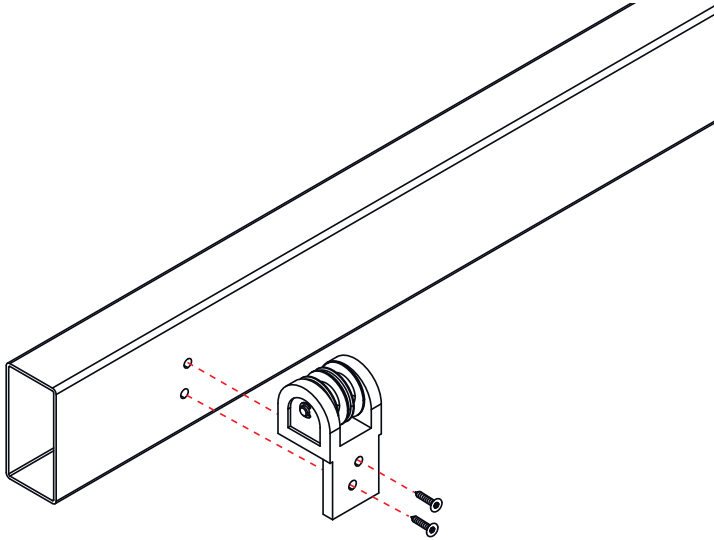

5.10 CANOPY OPTION

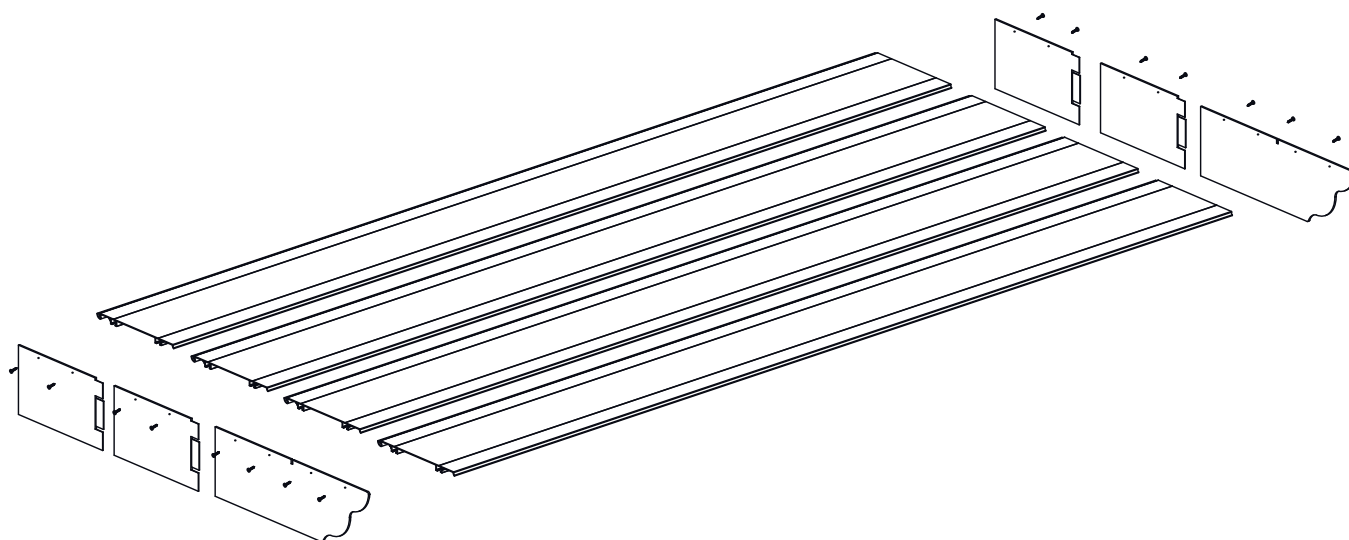

5.11 SUPPORT FIXING INSTALLATION

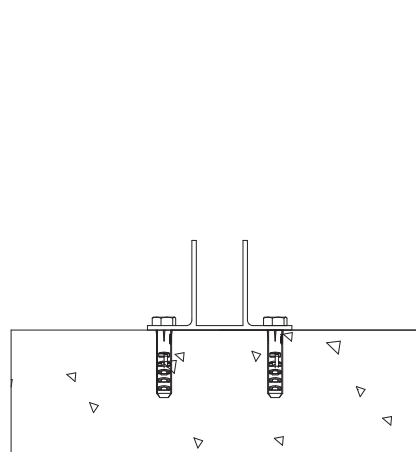
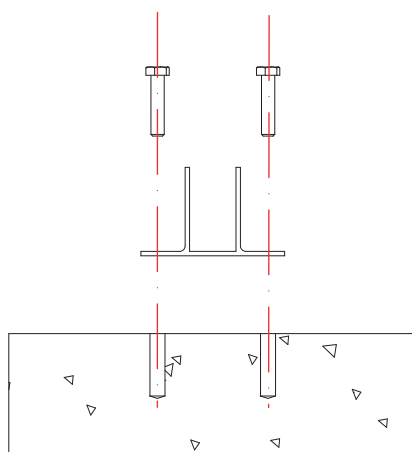
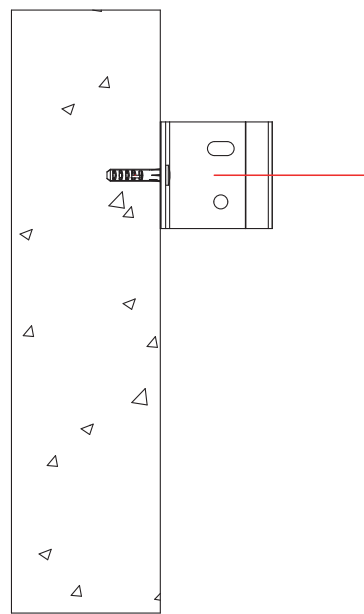
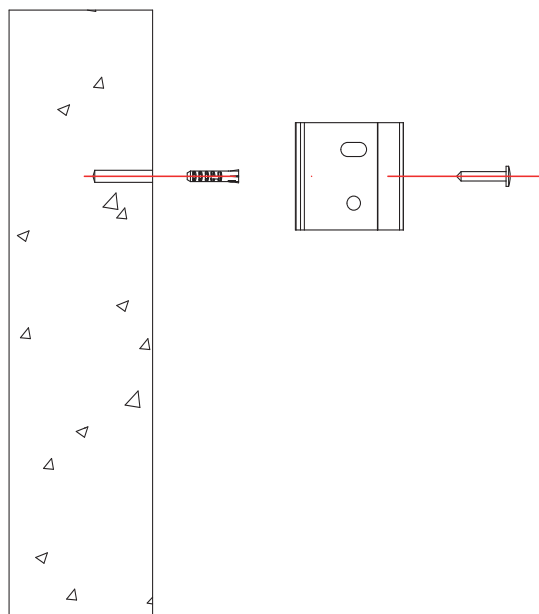

If it's a wall-to-wall installation:

Position the guide supports at the correct distance.
Both supports must be positioned at the same level.

Mark your position and proceed to drill the surface.

Finally, fix the supports to the surface with the corresponding anchors according to the type of surface.

If it's an installation without bars:

Position the guide supports at the correct distance.
Both supports must be positioned at the same level.

Mark your position and proceed to drill the surface.

Finally, fix the supports to the surface with the corresponding anchors according to the type of surface.

Repeat the operation with the foot supports (for the columns).

If it's an installation with bars:

Position the guide supports and foot supports (for the bars) at the correct distance. They must be positioned at the same level.

Mark your position and proceed to drill the surface.

Finally, fix the supports to the surface with the corresponding anchors according to the type of surface.

Repeat the operation with the foot supports (for the columns).

6. MAINTENANCE

6.1. CLEANING AND CARE

For best use and extended durability of the screen, it is recommended to carry out regular maintenance and checks at least once a year, or even more often depending on the wear and tear caused by wind at the installation site.

To prevent rusting, periodic cleaning of gutters and profiles using neutral soap is recommended. This should be done at least once a year and more frequently for materials exposed to aggressive atmospheric conditions (marine, industrial, airborne dust, etc.) It is important to thoroughly rinse the products with water after using detergents to clean them, to avoid the build-up of salts on the profiles' surfaces.

The appropriate performance of this periodic maintenance removes exogenous agents from the profiles' surface that may attack their covering and aluminium components, prolonging the lifespan of the profiles and maintaining their appealing aesthetic.

To clean the canvas, we recommend removing the dust that has accumulated without using water, to enable you to remove all the surface particles by vacuuming, air blowing, beating or brushing.

If you wish to remove finger or grease marks, use water with neutral soap. If they are water-based marks, clean them with at most a sponge and rub with a damp cloth.

NEVER use detergents or other chemical products.

Finally, the user must bear in mind the need to check the tightness of the screws in accordance with the tightening torques.

7.ANNEX III

7.1. DISASSEMBLY AND DISPOSAL OF THE PACKAGING AND COMPONENTS OF THE PRODUCT AT THE END OF ITS USEFUL LIFE

IMPORTANT

The packaging must be recycled by the authorised professional who installed the product.

We advise you to recycle the product packaging responsibly:

- Please dispose of this waste in accordance with the current regulations:
 - Directive 94/62/EC on packaging and packaging waste.
 - Spanish Law 11/1997 of April 24th on packaging and packaging waste.
- Please sort the waste by separating each and every one of the various materials, to facilitate effective disposal of the packaging.
- Do not dispose of packaging materials together with other types of waste. Take them to a packaging materials collection point designated by the local authorities.
- In order to minimise the environmental impact of packaging and packaging waste, it is necessary to define the composition and nature of the packaging

of our products to recommend their best disposal.

Paper and cardboard: In waste management, the recycling of paper and cardboard plays an important role, because up to 70% can be reclaimed. The disposal of paper and cardboard can be done through various channels such as collection by private operators or delivery to waste treatment plants.

Plastic: The recycling of plastics has many advantages for the environment and therefore benefits the quality of life of everyone, contributing to a greater saving of raw materials as well as natural, energy producing and economic resources. The disposal of plastic can be done by private operators or delivered to waste treatment plants.

Bubble wrap: This is made of low density polyethylene, which makes it 100 % recyclable. For optimal disposal, please deliver any waste comprising this material to plastic waste treatment plants.

OUR COMMITMENT TO THE ENVIRONMENT

One of Giménez Ganga's objectives is to maintain socially responsible behaviour. This commitment to the environment implies continuous improvements in the measures that are adopted to combat climate change.

Promoting responsible care of the environment, complying with the legal and regulatory requirements applicable to our products and promoting energy saving in all our projects are measures that are essential for us to achieve our objectives.

DISASSEMBLY AND REMOVAL OF THE PRODUCT

When disassembling this product, a number of precautionary measures must be taken. Observe the following warnings and instructions. Please contact your supplier with any queries.

Disassembly may only be carried out by experienced fitters. This manual is not intended for DIY enthusiasts or installers in training.

For more information on these disassembly instructions, please refer to the chapters regarding installation in this manual that contain diagrams and detailed information.

IMPORTANT

Always act with care.
Please only use suitable tools that are in perfect condition.

• Step 1

Close the canopy and remove the cable.

• Step 2

Loosen the screws on the covers of the aluminium double poles and remove the covers.

• Step 3

Remove the double poles from the guides by loosening the screws of the flanged pulleys that fix the poles to the guides.

• Step 4

Loosen the screws and remove the plugs from the double poles so that the canvas can be uncoupled.

• Step 5

Remove the plastic tubes from the canvas fold.

• Step 6

Loosen the screws that fix the guide profiles to the guide supports and remove the profiles (in case of wall-to-walls go directly to step 13).

• Step 7

Loosen the screws that fix the inner joint profile to the structural tube.

• Step 8

Loosen the screws that fix the bar to the inner joint profile.

IMPORTANT

The disassembly of the product at the end of its useful life must be carried out by qualified personnel. In order to carry it out, the steps that were carried out for its assembly must be performed in reverse.

• Step 9

Uncouple the beam from the bars and columns.

• Step 10

Loosen the screws that fix the columns to the foot supports and decouple the columns.

• Step 11

Loosen the screws that fix the bars to the foot supports and decouple the bars.

• Step 12

Remove the beam covers.

• Step 13

Loosen the anchors of the floor foot and/or wall supports and uncouple the supports.

• Step 14

Loosen the screws that fix the fitting to the surface and remove it.

• Step 15

Loosen the screws that fix the single and double trolley to the surface and to the beam and remove them.

• Step 16

Finally, if you have a canopy, loosen the screws that connect the canopy profiles and decouple them.

IMPORTANT

Ensure that you dispose of all pieces of the product taking into account the nature of their materials.

COMPONENTS	STEEL GALVANISED	STEEL STAINLESS	ALUMINIUM	WEEE	PLASTIC	TEXTILES
Profiles			•			
Screws		•				
Foot supports and guide supports			•			
Mounting brackets			•			
Profile covers					•	
Pulleys and mini-pulleys					•	
Fittings and trolleys					•	
Canvas						•

Our products are mainly made of recyclable materials. It is advisable to be informed about the recycling or disposal systems provided for under the current regulations in your country for this product category.

IMPORTANT

- Always act with great care. Please only use suitable tools that are in perfect condition.
- Ensure that you dispose of all pieces of the product taking into account the nature of their materials.



This symbol means that the product must not be disposed of together with household waste as it must be collected separately for recovery, reuse or recycling in accordance with local regulations.



In compliance with European Directive 2012/19/EU, waste electrical and electronic equipment (WEEE) can become a serious environmental problem if not managed properly. The Directive provides the general framework valid throughout the European Union for the disposal and re-use of waste electrical and electronic equipment.

At the end of the useful life of the electrical or electronic equipment, it must not be disposed of together with other types of waste. These items can be delivered to the specific centres regulated for this purpose by the local authorities.

The effective separation of waste will avoid negative consequences for the environment and health that could result from poor waste management or inadequate waste disposal.

IMPORTANT

By complying with this directive, you will be acting in favour of the environment and will contribute to the conservation of natural resources and the protection of health.

Local regulations may impose significant penalties for illegal disposal of the product.

THE MATERIALS THAT OUR PRODUCTS ARE MADE OF OFFER A GREAT VARIETY OF ENVIRONMENTAL ADVANTAGES



GALVANISED STEEL

Galvanised steel is a type of steel which undergoes a certain treatment, at the end of which it is coated with several layers of zinc which protect it, avoiding oxidation. Recycling zinc helps reduce demand for new materials and, as a result, generates considerable energy savings, as it is a metal that constitutes a very valuable and sustainable resource.

For proper recycling of galvanised steel, it is advisable to visit a metal waste collection centre.



STAINLESS STEEL

Stainless steel is an iron alloy containing nickel and chromium to protect against corrosion and rust. Its qualities include resistance to high temperatures and notable strength. Stainless steel is an infinitely recyclable "green material". Its properties make it ideal for exposure to poor weather conditions.

Therefore, to ensure proper disposal of stainless steel, it is recommended that this material be left at a specialised waste collection centre.



ALUMINIUM

Recycling aluminium guarantees an endless variety of environmental benefits. The use of recycled aluminium saves 95% of the energy used in its production from the material's raw state. It can be recycled as many times as desired and is fully recoverable. Therefore, recycling aluminium is both technically and economically profitable.

Therefore, to ensure proper disposal of aluminium, it is recommended that this material be left at a specialised waste collection centre.



CABLES

Recycling electrical cables prevents the contamination that can be caused by these elements. Recycling cables allows for the subsequent use of the copper, aluminium and brass the cables contain, once they are separated from their plastic insulation.

Electrical and electronic waste must be taken to clean points for proper recycling.



PET



HDPE



PVC



LDPE



PP



PS



OTHER

PLASTIC

Plastic recycling provides a sustainable source of raw materials for industry. Its reuse also significantly reduces environmental problems, as it is a non-biodegradable material.

Recycling reduces energy consumption and CO2 emissions, thus mitigating pollution and climate change.

There are several types of plastic, so to achieve optimal recycling it is essential to deposit them at clean points where the different types will be separated and identified.



TEXTILES

Making use of textile waste is essential when we talk about recycling. Reuse of such waste helps to reduce the consumption of water and gases that are released in the manufacturing process.

In order to encourage the proper disposal of textiles, it is recommended that they be left at a specialised waste centre where the different textile fibres will be separated.

IMPORTANT

Follow the recommendations for effective product recycling. Remember that recycling is more than an action; it is the valuable act of accepting responsibility for the preservation of natural resources.

