

RV BOX MOSQUITO SCREEN

ASSEMBLY MANUAL





IMPORTANT

It is important for the safety of persons and the integrity of the product to read these instructions carefully before installing, operating, repairing or using the mosquito screen for the first time.

This document is an integral part of the titled mosquito screen model and is intended for the installer. It contains specific information regarding its cutting and a complete guide of the sequence of operations for its assembly and installation.

It also contains information required to give presumption of conformity with the European Construction Products Directive and European Standard EN 13561 as regards accompanying documents.

Information on general requirements for the use, handling, installation, maintenance and disposal of the mosquito screen can be found in the document **"Mosquito screens: prescriptions for the user and installer"** available at gimenezganga.com.

Both documents constitute a complete instruction manual and are an essential tool to properly operate your mosquito screen throughout its life cycle: installation, use, maintenance and disposal at the end of its useful life.

We recommend that you download both documents and keep them linked to the mosquito screen for future reference. The information they contain is an essential part of the product.

INDEX

| | |
|---|-----------|
| 01 COMPONENTS | 04 |
| 1.1 RV BOX MOSQUITO SCREEN CUTTING | 04 |
| 1.2 PROFILES | 05 |
| 1.3 TECHNICAL CHARACTERISTICS | 05 |
| 02 ASSEMBLY INSTRUCTIONS | 06 |
| 03 DISASSEMBLY AND DISPOSAL OF THE PACKAGING AND COMPONENTS OF THE PRODUCT AT THE END OF ITS USEFUL LIFE | 10 |
| 3.1 DISASSEMBLY MOSQUITO SCREEN | 10 |
| 3.2 PACKAGING DISPOSAL | 13 |
| 3.3 DISASSEMBLY AND DISPOSAL OF THE PRODUCT | 13 |

01 COMPONENTS

1.1 RV BOX MOSQUITO SCREEN CUTTING

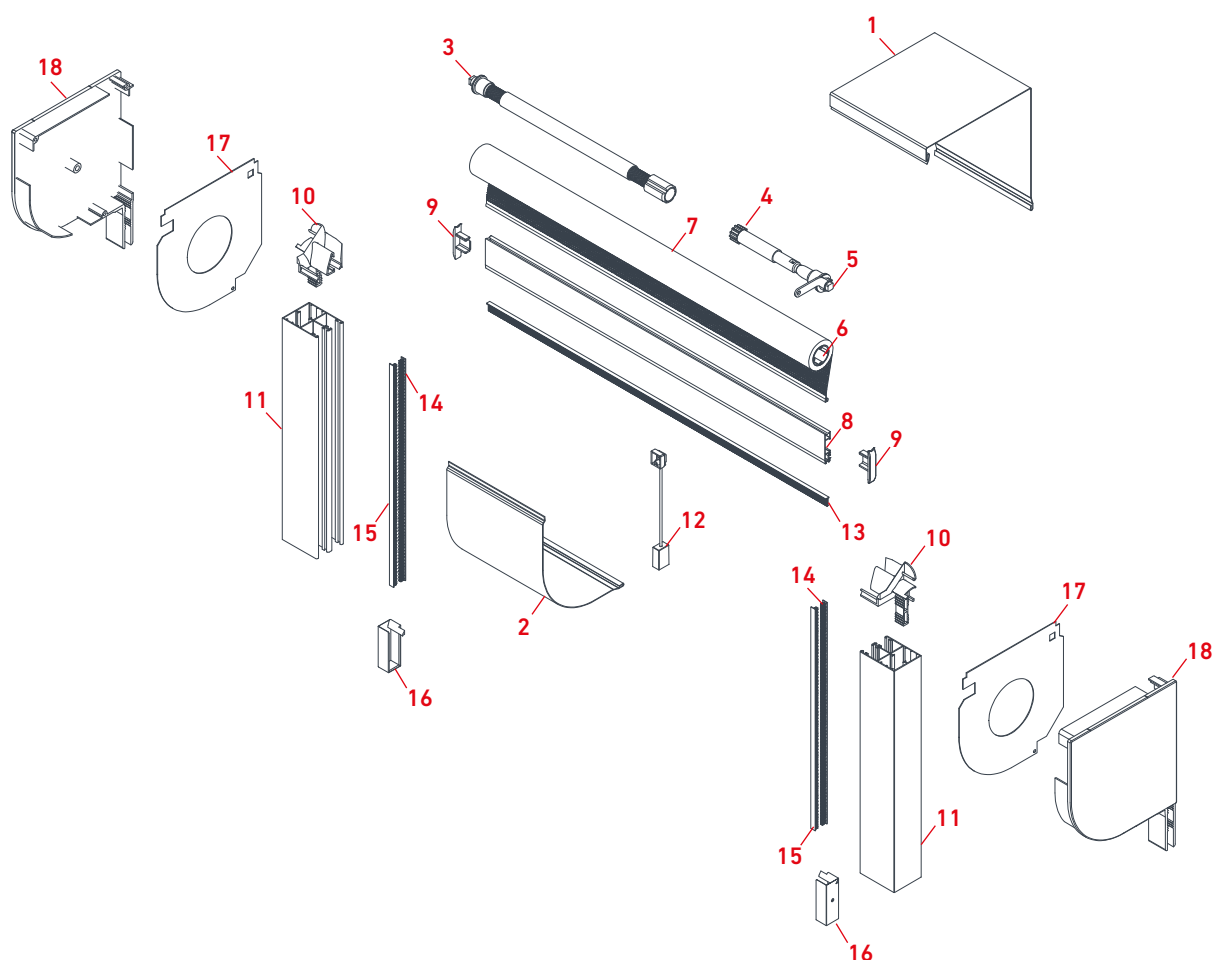

| REF. | DESCRIPTION |
|------|--|
| 1 | 027227 Box Top profile RV-165 GG |
| 2 | 027267 Curved Box Opening profile RV-165 GG |
| 3 | 008115 Fixed axle 25 mm (Mesh) MRV |
| 4 | 008896 Kit Mosquito screen RV Mesh 35 with Decelerator |
| 5 | 008116 Retractable axle 25 mm (Decelerator) MRV |
| 6 | 008609 Axle Ø25 mm |
| 7 | 008096 Fiberglass to mosquito screen |
| 8 | 008502 RV Mosquito screen terminal |
| 9 | 008119 Set. RV end cap MRV |
| 10 | 008117 Set. MRV double guide entry |

| REF. | DESCRIPTION |
|------|--|
| 11 | 008501 RV Mosquito screen Double guide |
| 12 | 008124 MRV Handle |
| 13 | 008678 Brush 5x14 mm - Terminal with Mosquito screen |
| 14 | 026015 Brush Ref.: 69-550 |
| 15 | 008503 Windscreen Brush MRI 5,4 X 16 mm |
| 16 | 008118 Set. Hidden brake MRV double guide |
| 17 | 027314 Safety Plates RV-M.S. 165 Opening profile axle 42 |
| 18 | 044001 Set of end caps T-165 ZF Opening profile |

1.2 PROFILES

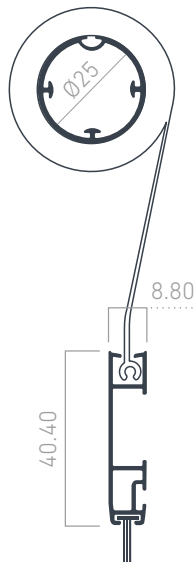

008899 Axle with fabric 180 with end slat and brush.

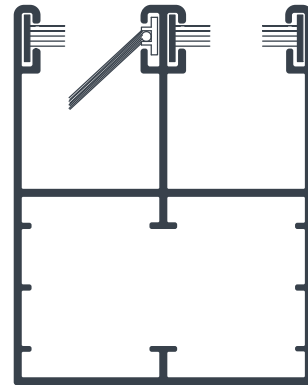

008898 RV Mosquito Screen Double Guide with windscreen brush and Film.

1.3 TECHNICAL CHARACTERISTICS

During use, the ends of the terminal run along the inside of the guides, the side caps being hidden and guaranteeing great resistance to wind load and high durability against ageing due to the action of UV rays.

“Easy Clip”

The special design of the “Easy Clip” accessories, allows the safe pre-loading and counting of spring turns on the outside of the box, using the Locking tool.

The new “Easy Clip” concept allows the installation of the set within the box using a retractable shaft, without the need for tools or fixing screws, considerably reducing installation time.

In order to prevent the axle from falling off during transport and during use of the product throughout its useful life, the “Easy Clip” design has a safety system that locks the retractable axle with the Locking tool.

The set of guide entries located in the mouths of the guides, houses the terminal in the open position of the mosquito screen and avoids the return of the terminal to the inside of the drawer.

The external shape of the terminal incorporates a longitudinal slot that allows the operation of the screen, acting on the terminal itself or using the MRV Handle with thread, which makes deployment of the screen easier.

To ensure safe use of the mosquito net, it is possible to use a decelerator which slows down the opening speed. On the other hand, for closing, a set of hidden brakes is used, which uses the traction of the spring itself to immobilize the terminal and is unlocked using a coordinated pressure and angle based movement.

02 ASSEMBLY INSTRUCTIONS

STEP 1

Carry out the cutting of the box profiles:

Box cutting= WIDTH -10 mm

Mosquito screen axle cutting= WIDTH -77mm

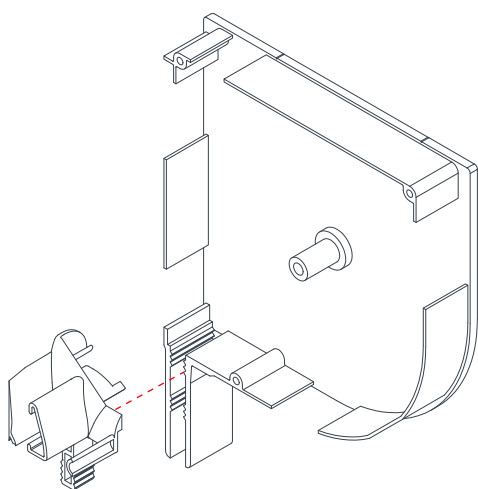
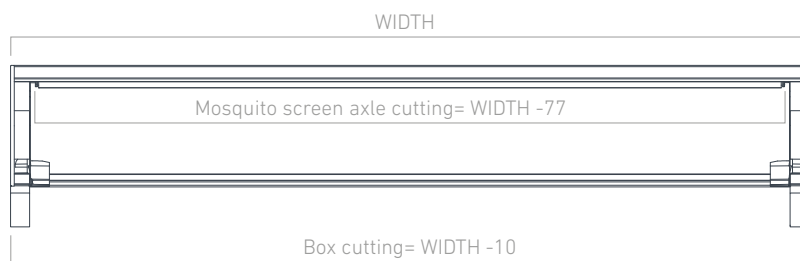

STEP 2

Assemble the subset of end caps with the MRV Double Guide Entry Set.

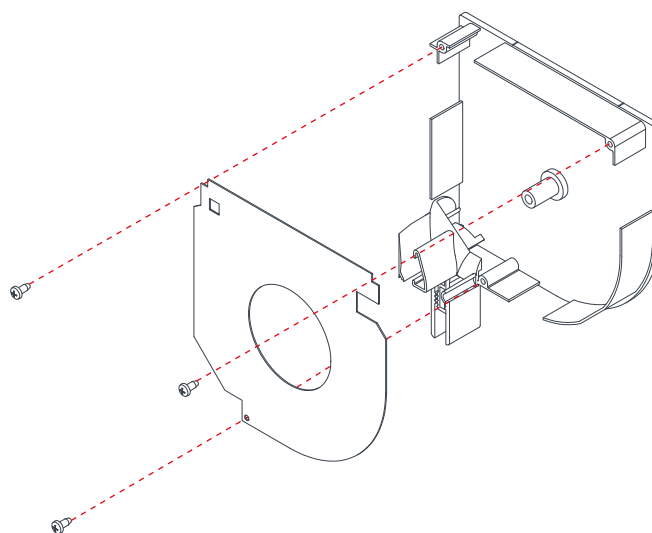

STEP 3

Then assemble the safety plates, according to the type of axle and accessories to be installed.

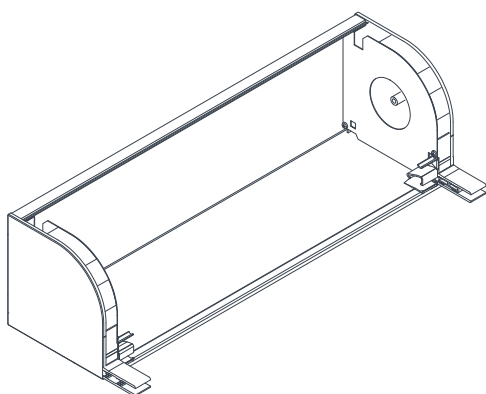

STEP 4

Next, assemble the box and keep to one side for the following processes.

STEP 5

Insert the handle in the central area of the terminal and fix it by means of a 1.5mm Allen bolt.

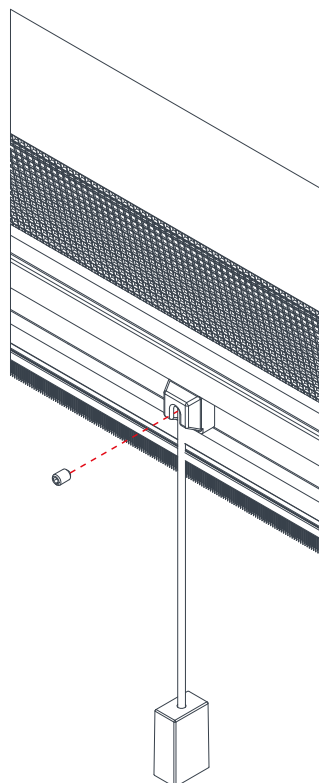

STEP 6 Then install the MRV Terminal Cap Kit.

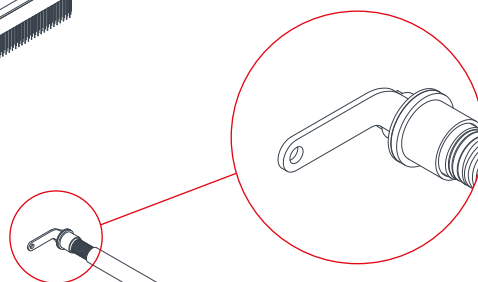
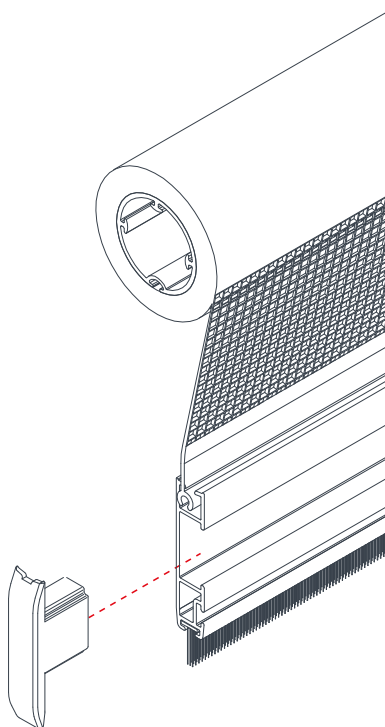

STEP 7

Then insert the end of the fixed axle and the end of the retractable axle into the inside of the 25mm axle as per the following images.

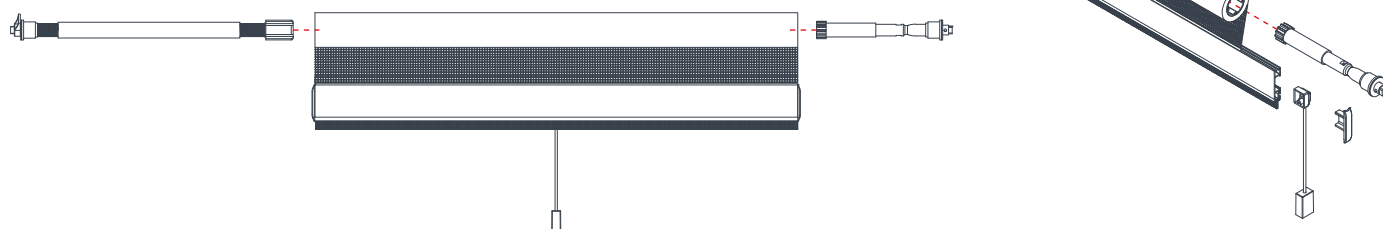

STEP 8

Insert the Locking tool in the fixed axle and proceed to load the spring turns.

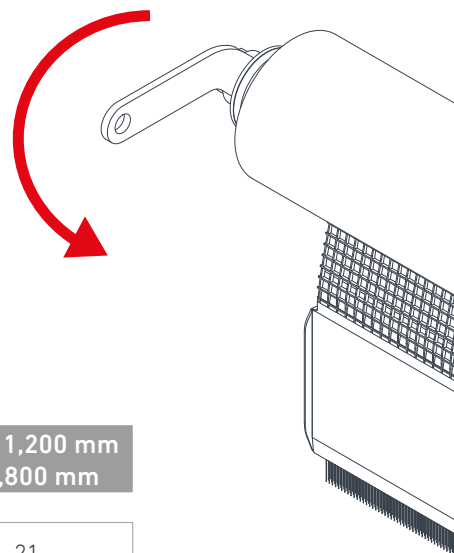

SPRING LOADING TABLE

(Number of turns recommended depending on height).

| REF. | DESCRIPTION | Up to 1,200 mm | From 1,200 mm to 1,800 mm |
|--------|--|----------------|---------------------------|
| 008894 | RV Mosquito screen Mesh KIT 50 with decelerator | 21 | 21 |
| 008896 | RV Mosquito screen Mesh KIT 35 with decelerator | 8 | 10 |
| 008895 | RV Mosquito screen Mesh KIT 50 without decelerator | 21 | 21 |
| 008897 | RV Mosquito screen Mesh KIT 35 without decelerator | 8 | 10 |

STEP 9

Next, insert the retractable axle end into the square housing of the left safety plate, press and insert the end of the fixed axle into the square housing of the right safety plate using the locking tool.

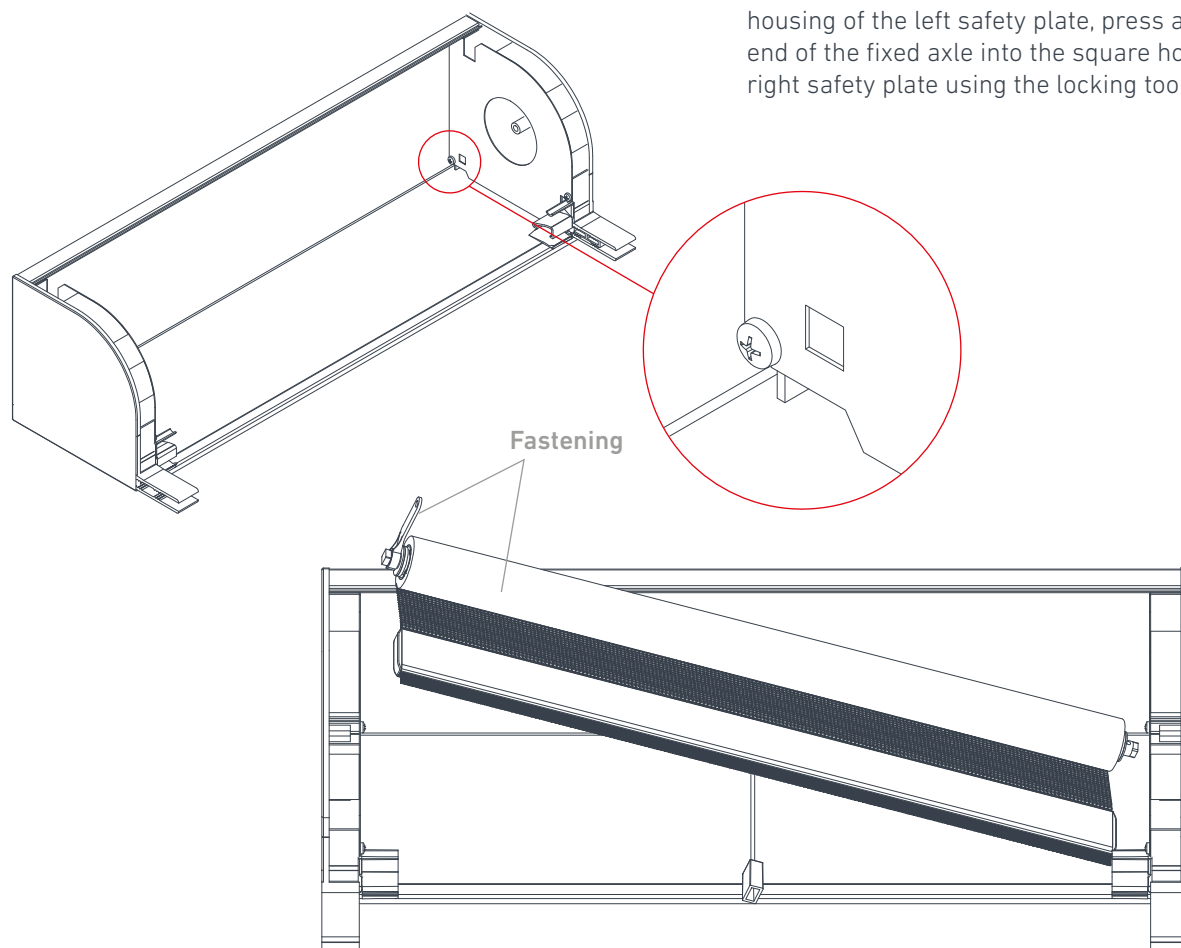

STEP 10

To prevent the mosquito screen axle from detaching during transport and use, remove the Locking tool from the end of the fixed axle and insert it into the end of the retractable axle.

At this point, we extract the MRV mosquito screen terminal through the guide entries, leaving the box ready for installation in its final location.

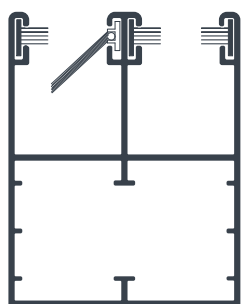
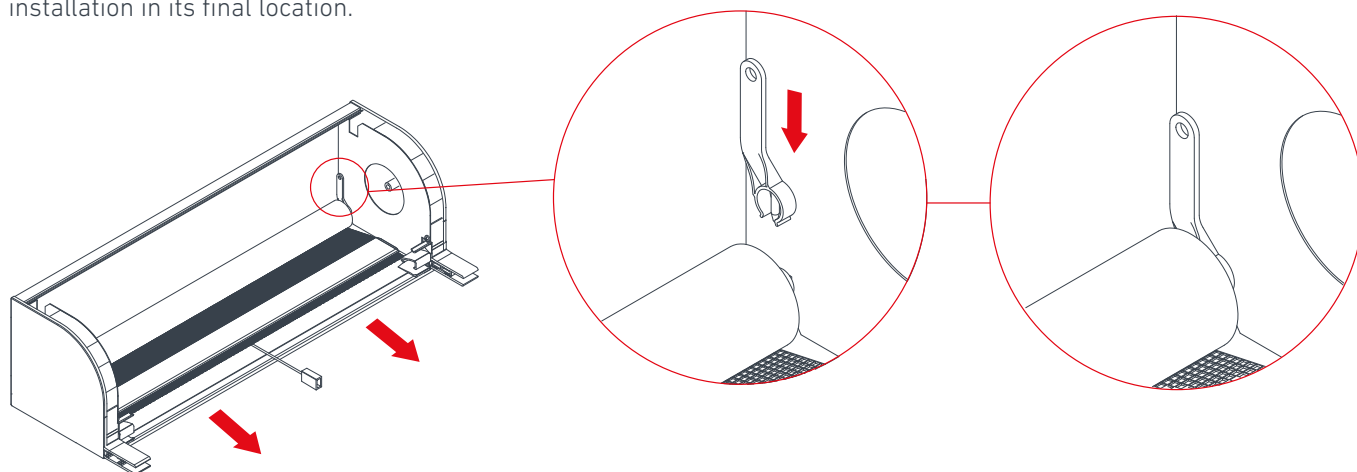

Double Guide

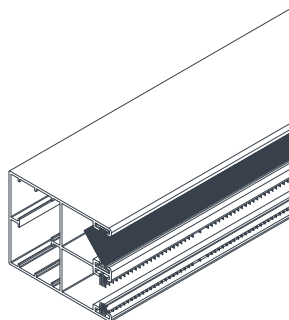

STEP 11

To prepare the guides, insert the Hidden Brake Double Guide Set in the end of the guides, taking into account its position and fix it with the screw inside the guides.

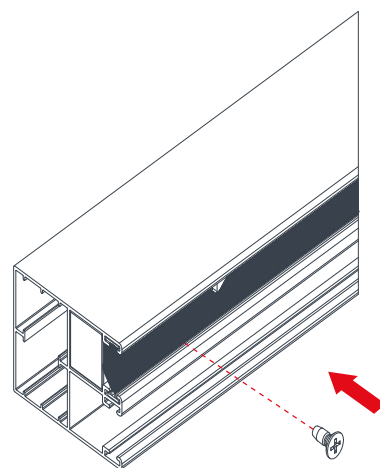
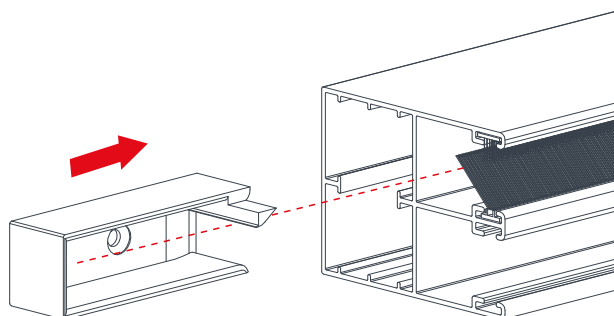

03 DISASSEMBLY AND DISPOSAL OF THE PACKAGING AND COMPONENTS OF THE PRODUCT AT THE END OF ITS USEFUL LIFE

3.1 DISASSEMBLY MOSQUITO SCREEN

STEP 1

With the screen partially unfolded, tilt the terminal until it loses enough length to remove it from the guides and insert it into the box.

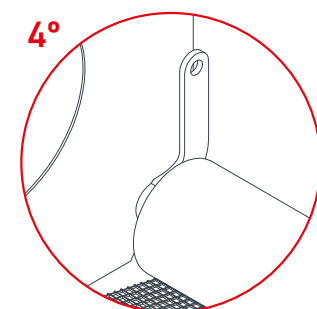
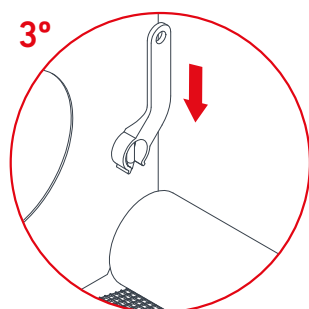
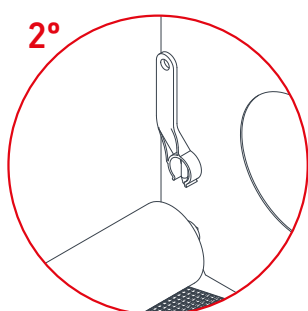
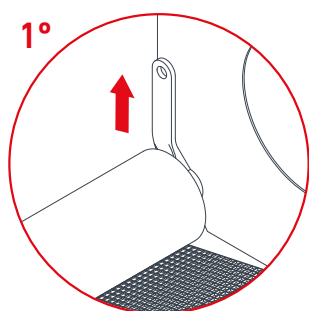
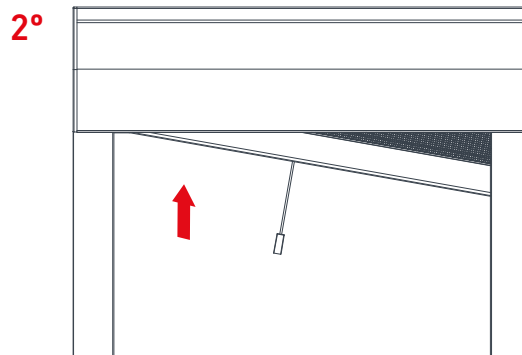
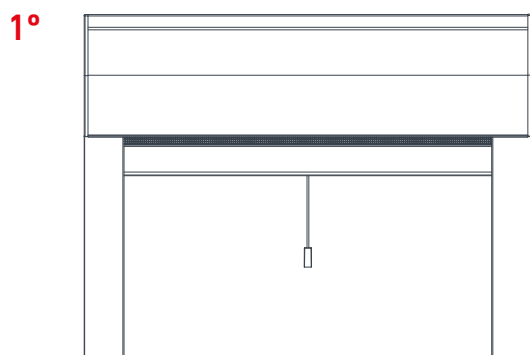

STEP 2

Remove the locking tool from the Retractable axle and insert it into the fixed axle.

STEP 3

Maintaining torque through the locking tool, press to retract the axle and remove the mosquito screen.

1°

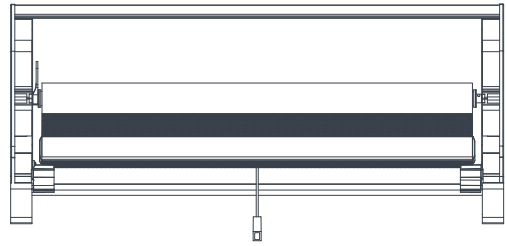

2°

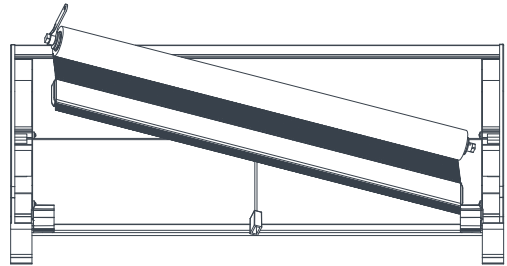

STEP 4

Carefully remove the spring load. Then remove the spring and the decelerator from the axle. Then remove the end caps, loosen the handle screw and proceed to disassemble the end of the fabric.

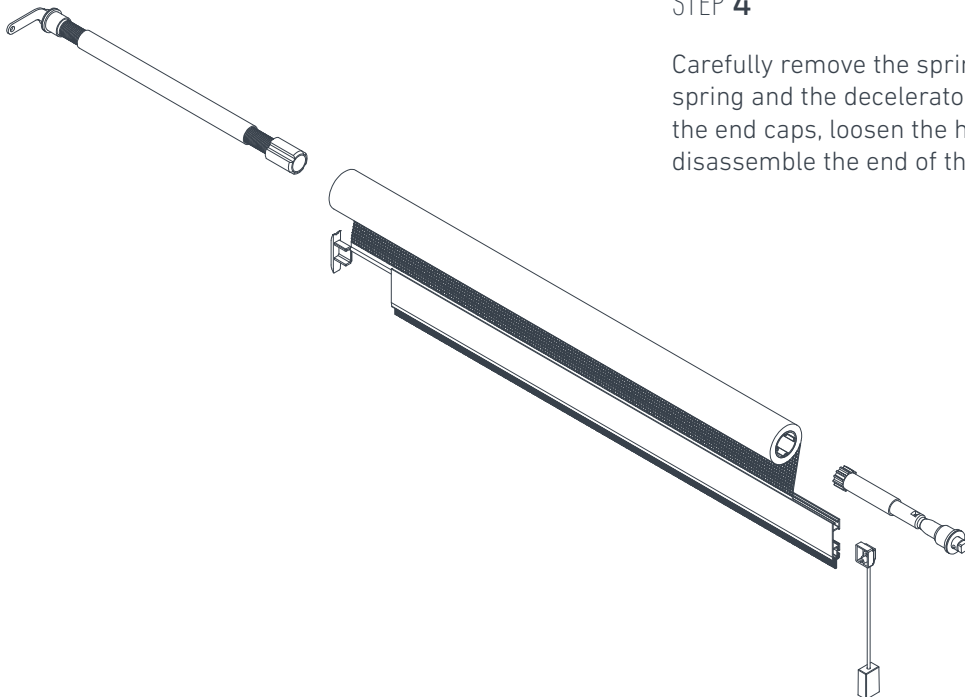

STEP 5

Remove the cloth from the shutter. Then remove the box from the guides and uninstall the box cover.

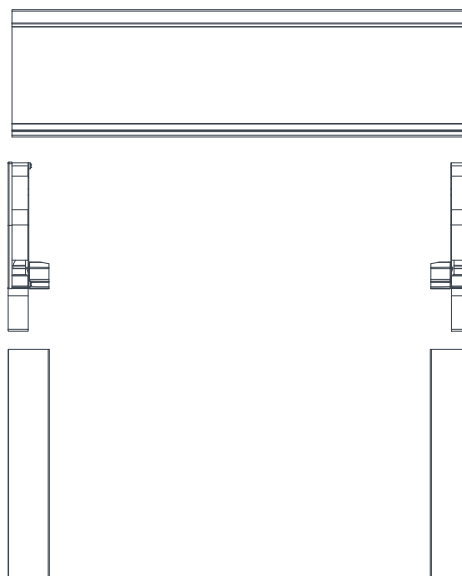
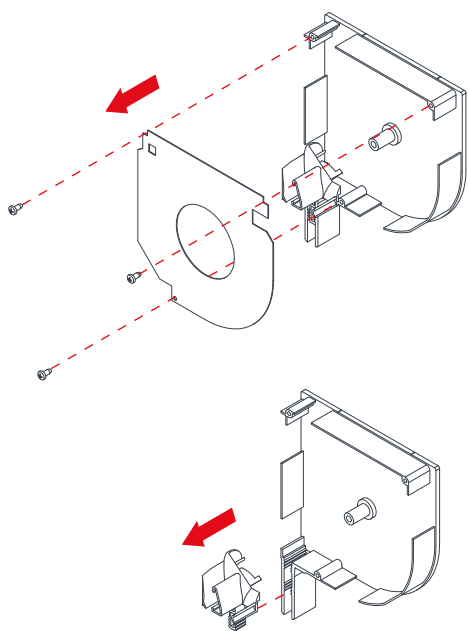

STEP 6

Remove the inner brake screw from the guide.

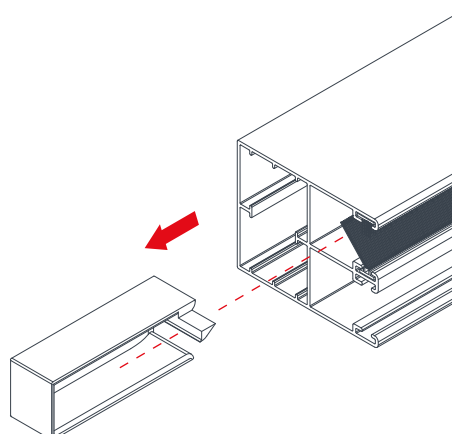
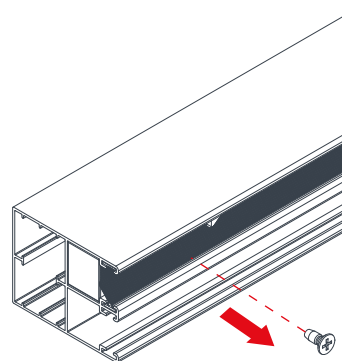

3.2 PACKAGING DISPOSAL

IMPORTANT

The packaging must be recycled by the authorised professional who installed the product.

We advise you to recycle the product packaging responsibly:

- **Please dispose of this waste in accordance with the current regulations:**

Directive 94/62/CE, on packaging and packaging waste.

Spanish Law 11/1997, of April 24th on packaging and packaging waste.

- **Please sort the waste by separating each and every one of the various materials, to facilitate effective disposal of the packaging.**
- **Do not dispose of packaging materials together with other types of waste. Take them to a packaging materials collection point designated by the local authorities.**
- **In order to minimize the environmental impact of packaging and packaging waste, it is necessary to define the composition and nature of the packaging of our products to recommend their best disposal:**

Paper and cardboard:

In waste management, the recycling of paper and cardboard plays an important role, because up to 70% can be reclaimed. The disposal of paper and cardboard can be done through various channels such as collection by private operators or delivery to waste treatment plants.

Plastic: The recycling of plastics has many advantages for the environment and therefore benefits in the quality of life of everyone, contributing to a greater saving of raw materials as well as natural, energy producing and economic resources. The disposal of plastic can be done by private operators or delivered to waste treatment plants.

Film alveolar: This is made of low density polyethylene, which makes it 100% recyclable. For optimal disposal, please deliver any waste comprising this material to plastic waste treatment plants.

OUR COMMITMENT TO THE ENVIRONMENT

One of Giménez Ganga's objectives is to maintain socially responsible behaviour. This commitment to the environment implies continuous improvements in the measures that are adopted to combat climate change.

Promoting responsible care of the environment, complying with the legal and regulatory requirements applicable to our products and promoting energy saving in all our projects are measures that are essential for us to achieve our objectives.

3.3 DISASSEMBLY AND DISPOSAL OF THE PRODUCT

IMPORTANT

The disassembly of the product at the end of its useful life must be carried out by qualified personnel, and in order to carry it out, the reverse steps that were carried out for its assembly must be performed.

When disassembling this product, a number of precautionary measures must be taken. Observe the following warnings and instructions. Please contact your supplier with any queries.

Disassembly may only be carried out by experienced fitters. This manual is not intended for DIY enthusiasts or installers in training.

For more information on these disassembly instructions, please refer to the chapters regarding installation in this manual that contain diagrams and detailed information.

Our products are mainly made of recyclable materials. It is advisable to be informed about the recycling or disposal systems provided for in the current regulations in your country for this product category.

IMPORTANTE

- Always act with care. Please only use suitable tools that are in perfect condition.
- Ensure that you dispose of all pieces of the product taking into account the nature of its materials.



This symbol means that the product must not be disposed of together with household waste as it must be collected separately for recovery, reuse or recycling in accordance with local regulations.



In compliance with European Directive 2012/19/EU, waste electrical and electronic equipment (WEEE) can become a serious environmental problem if not managed properly. The Directive provides the general framework valid throughout the European Union for the disposal and re-use of waste electrical and electronic equipment.

At the end of the service life of the electrical or electronic equipment, it must not be thrown away together with other types of waste. They can be delivered to the specific centres regulated for this purpose by the local authorities.

The effective separation of waste will avoid negative consequences for the environment and health that could result from poor waste management or inadequate waste disposal.

IMPORTANT

By complying with this directive, you will be acting in favour of the environment and will contribute to the conservation of natural resources and the protection of health.

Local regulations may impose significant penalties for illegal disposal of the product.

THE MATERIALS THAT OUR PRODUCTS ARE MADE OF OFFER A GREAT VARIETY OF ENVIRONMENTAL ADVANTAGES



GALVANISED STEEL

Galvanised steel is a type of steel which undergoes a certain treatment, at the end of which it is coated with several layers of zinc which protect it, avoiding oxidation. Recycling zinc contributes to reducing the demand for new materials and, as a result, causes considerable energy savings, being a metal that constitutes a very valuable and sustainable resource.

For proper recycling of galvanised steel, it is advisable to visit a metal waste collection centre.



STAINLESS STEEL

Stainless steel is an iron alloy containing nickel and chromium to protect against corrosion and rust. Its qualities include resistance to high temperatures and being a particularly strong material. Stainless steel is an infinitely recyclable "green material". Its properties make it ideal for exposure to the elements.

Therefore, to ensure proper disposal of stainless steel, it is recommended that this material be left at a specialised waste collection centre.



ALUMINIUM

Aluminium recycling guarantees an endless variety of environmental benefits. The use of recycle aluminium saves 95% of the energy used in its production in its raw state, and it can be recycled as many times as desired and is fully recoverable. For all these reasons, aluminium recycling is profitable both from a technical as well as an economic point of view.

Therefore, to ensure proper disposal of aluminium, it is recommended that this material be left at a specialised waste collection centre. en un centro de recogida de residuos especializado.



CABLES

The recycling of electrical cables prevents the contamination that can come from these elements. Its recycling allows for the subsequent use of the copper, aluminium and brass from the cables, once they are separated from their plastic insulation.

Electrical and electronic waste must be taken to clean points for proper recycling.



PET



HDPE



PVC



LDPE



PP



PS



OTHER

PLASTIC

Plastic recycling provides a sustainable source of raw material for the industry. Its reuse also significantly reduces environmental problems, as it is a non biodegradable material.

Recycling reduces energy consumption and CO² emissions, thus mitigating pollution and climate change.

There are several types of plastic, so to achieve optimal recycling it is essential to deposit them in clean points where the separation of the different types and their identification will take place.



TEXTILES

The use of textile waste is essential when we talk about recycling. Reuse helps to reduce water consumption, and the gases that are released in the manufacturing process.

In order to facilitate the proper disposal of textiles, it is recommended to deposit them at a waste centre where they will be separated into the different textile fibres.

IMPORTANT

Follow the recommendations for effective product recycling. Remember that recycling is more than an action; it is the value of accepting responsibility for the preservation of natural resources.

